

KISS Quattro Abutment System

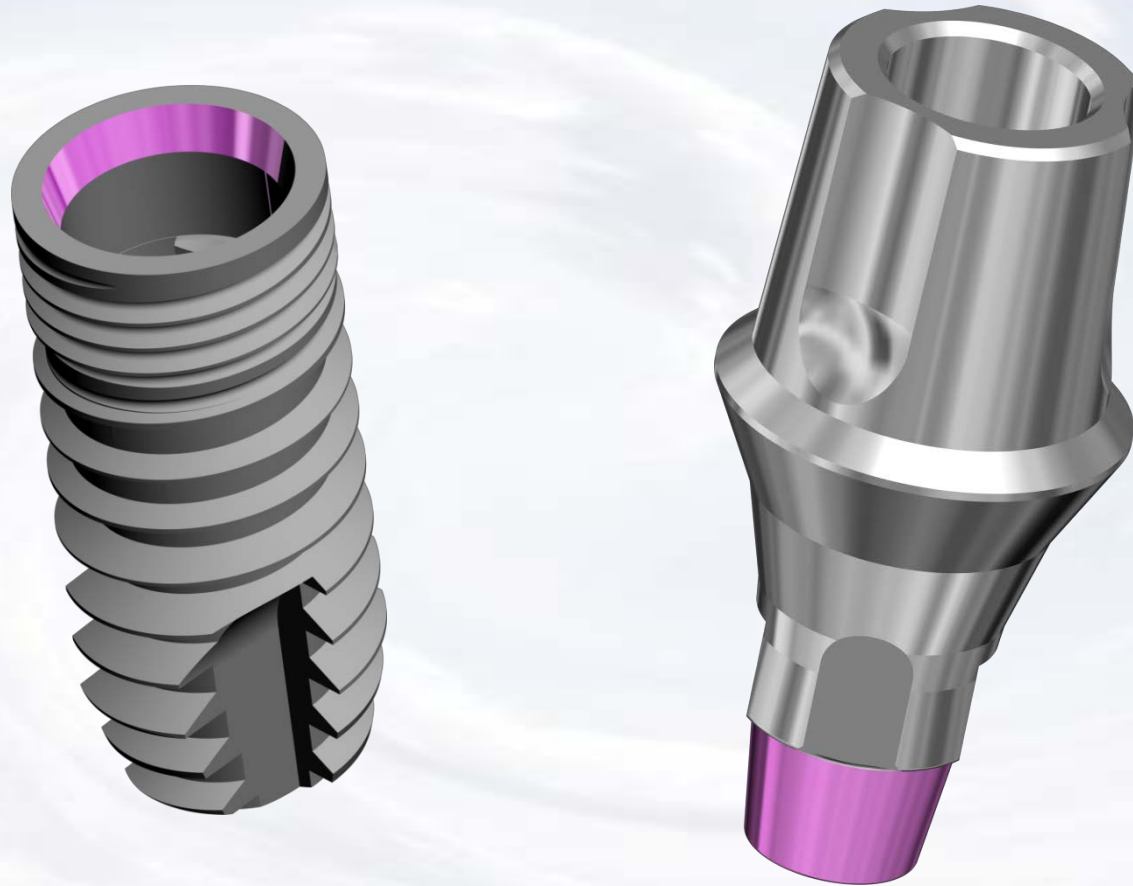

Blue Sky Bio

KISS Quattro Abutment System



Choose matching
abutment

Healing abutment in place

The presentation that follows lists only one combination of parts. Obviously the clinical situation may call for substitution of another part on this slide.

Regular Platform



Size	Part #
Regular KISS Complete Kit 1.5mm collar	KASKSQR15
Regular KISS Abutment 1.5mm collar	ASKSQR15
KISS Abutment Analog	BMKISR
KISS Impression Kit	KIKR

Wide Platform







Size	Part #
Wide KISS Complete Kit 1.5mm collar	KASKSQW15
Wide KISS Abutment 1.5mm collar	ASKSQW15
KISS Abutment Analog	BMKISR
KISS Impression Kit	KIKR



Blue Sky Bio

KISS Quattro Abutment System

	Size	Part #
	Torque/Ratchet Wrench	TR-900-01
		ITI-Adapter
		SDS048
		SDL048

Prosthetic instruments needed



Blue Sky Bio

KISS Quattro Abutment System

Assemble screw driver with
Thumb Knob

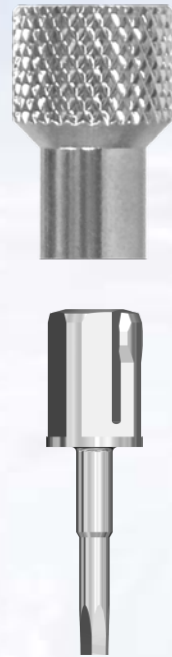

Remove healing abutment
from implant

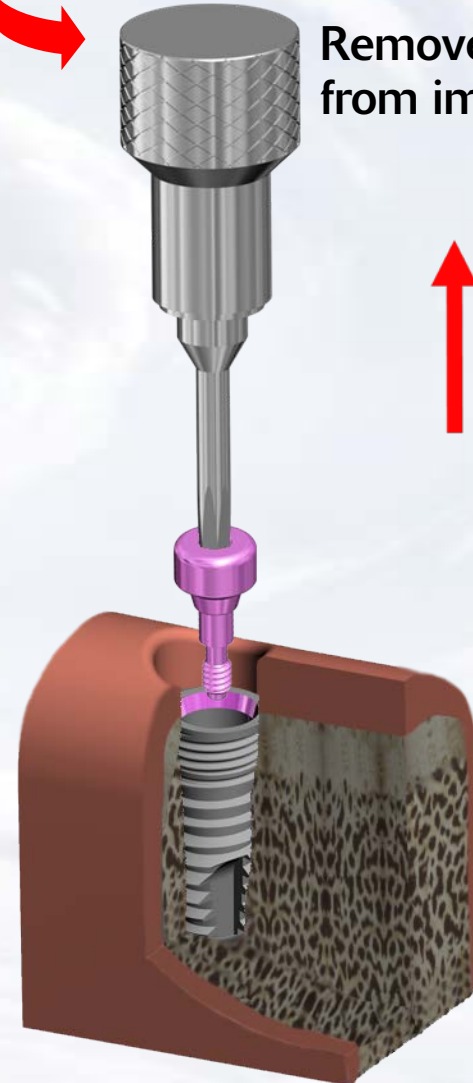

Blue Sky Bio

KISS Quattro Abutment System

Insert the Kiss abutment into the implant ensuring the appropriate orientation

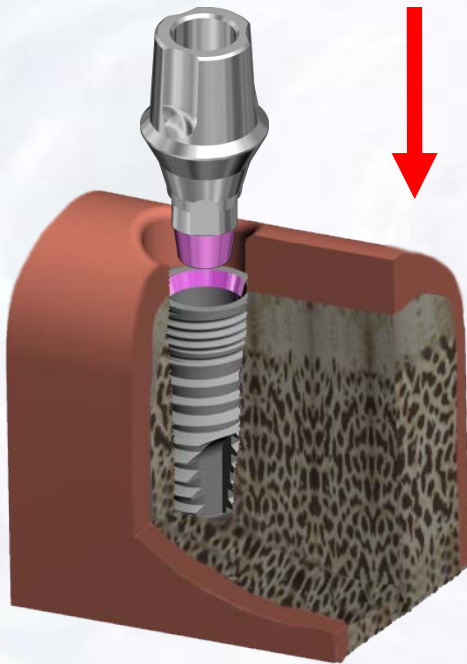

Use only light finger pressure to torque screw

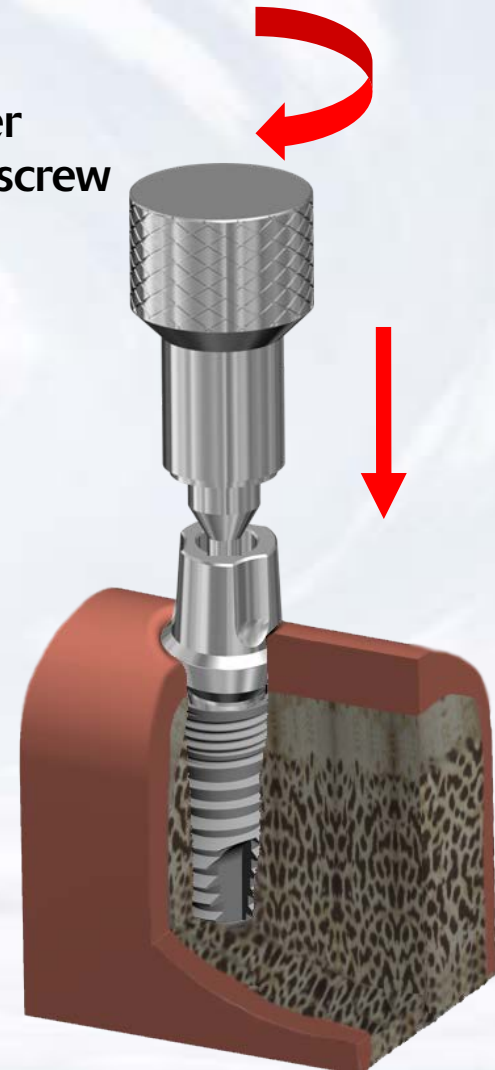

Blue Sky Bio

KISS Quattro Abutment System

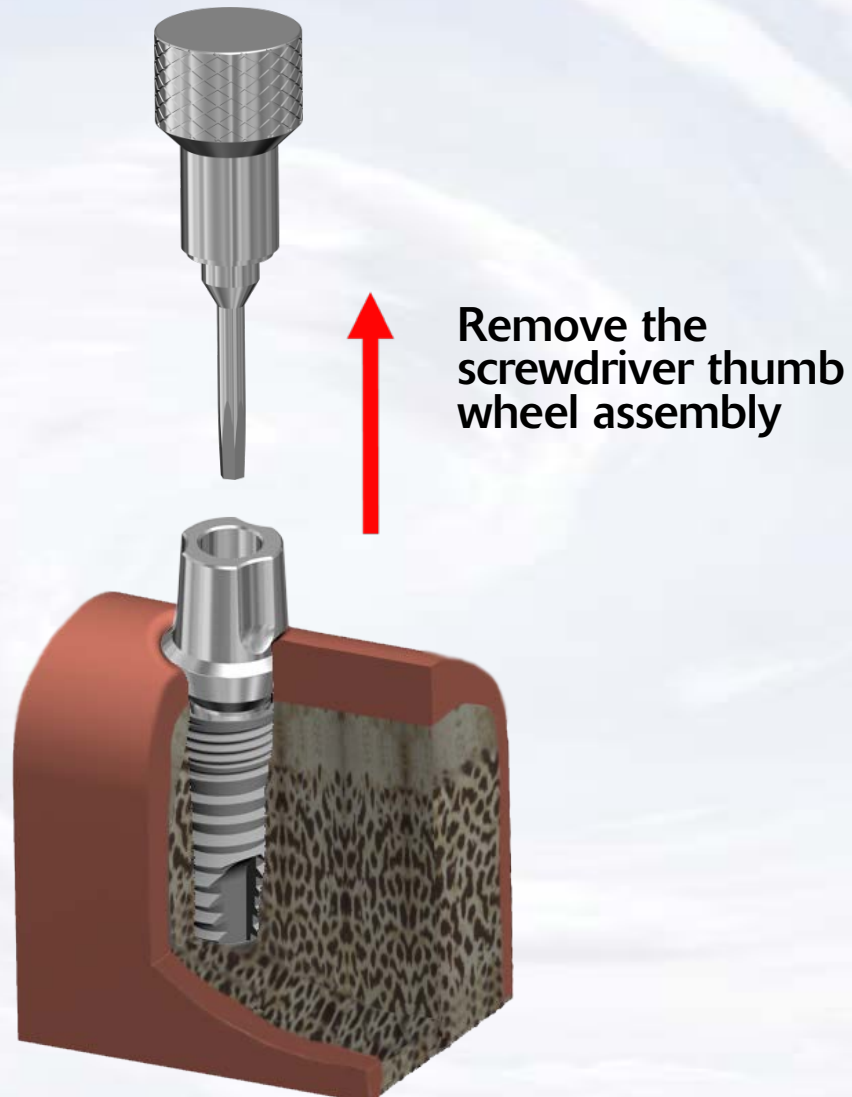

Blue Sky Bio

KISS Quattro Abutment System

Insert the hex driver within the 30Ncm torque ratchet



Insert driver into the abutment screw and turn torque ratchet until torque of 30 Ncm is reached and the head of the ratchet releases

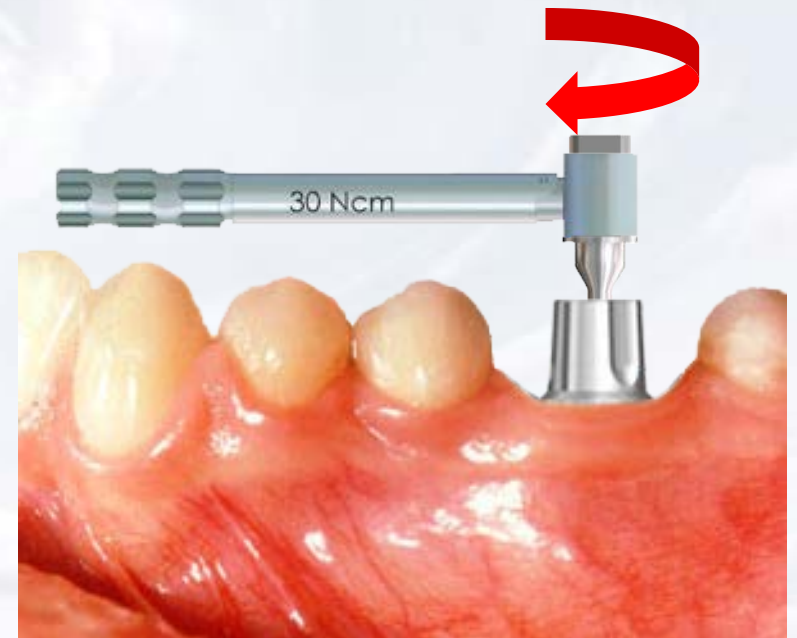

Blue Sky Bio

KISS Quattro Abutment System

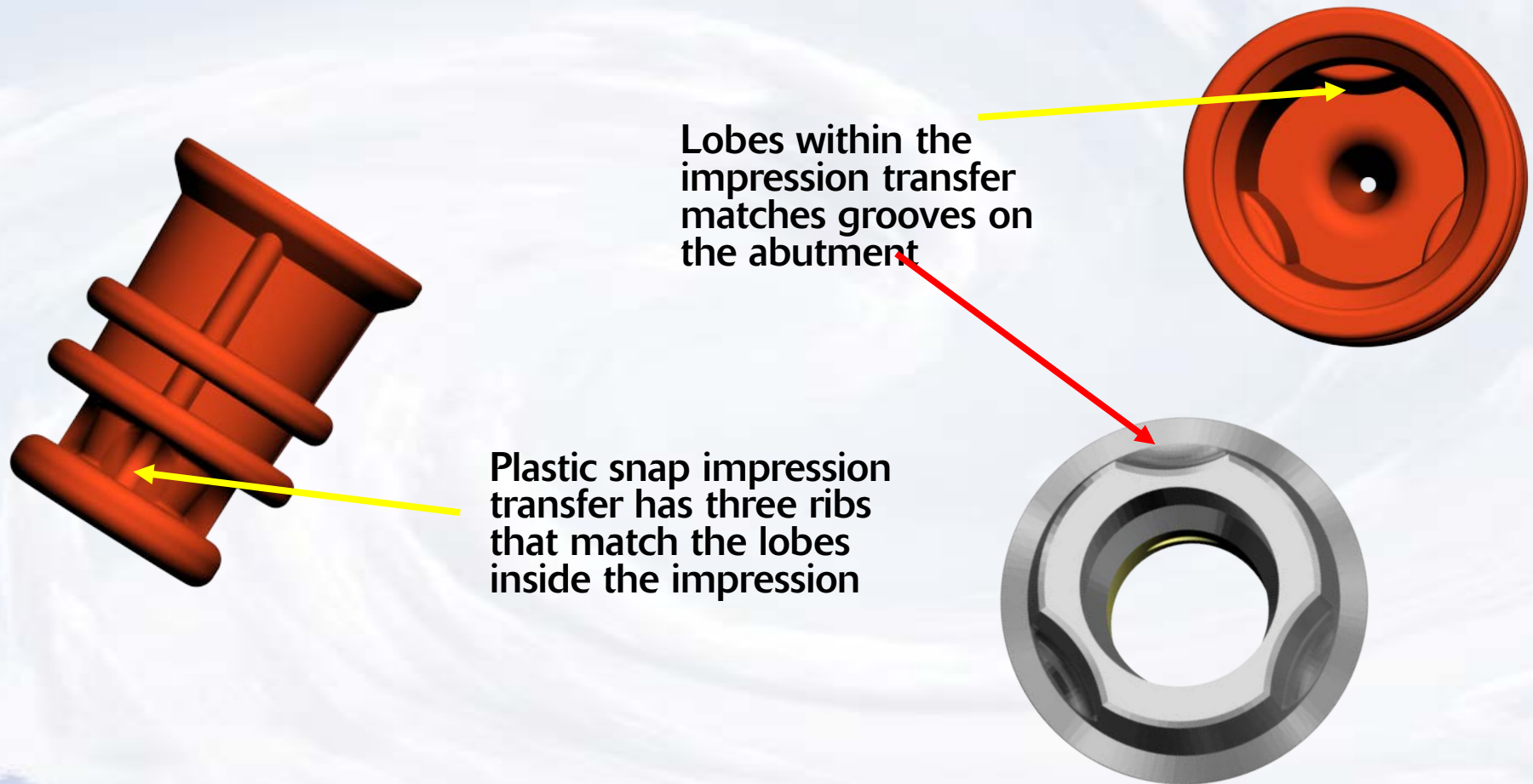

Blue Sky Bio

KISS Quattro Abutment System

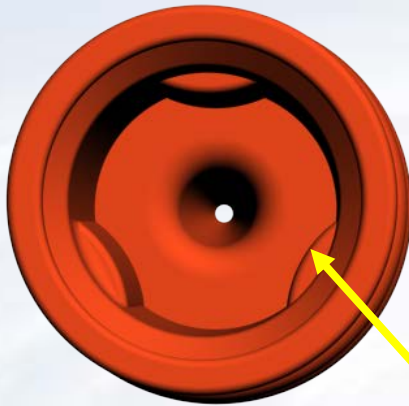

Line up the lobes of the snap impression coping with the grooves of the KISS Abutment



Seat snap impression coping on the solid abutment

The outside should snap on the bevel of the implant.



Blue Sky Bio

KISS Quattro Abutment System

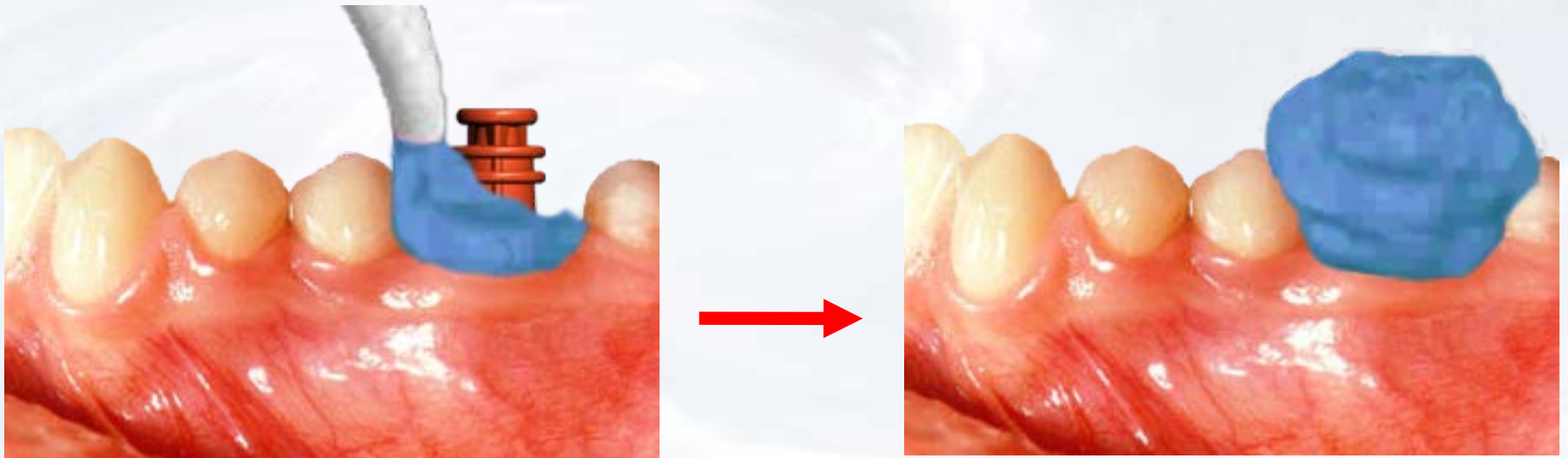

Inject impression material around the
impression transfer



Blue Sky Bio

KISS Quattro Abutment System

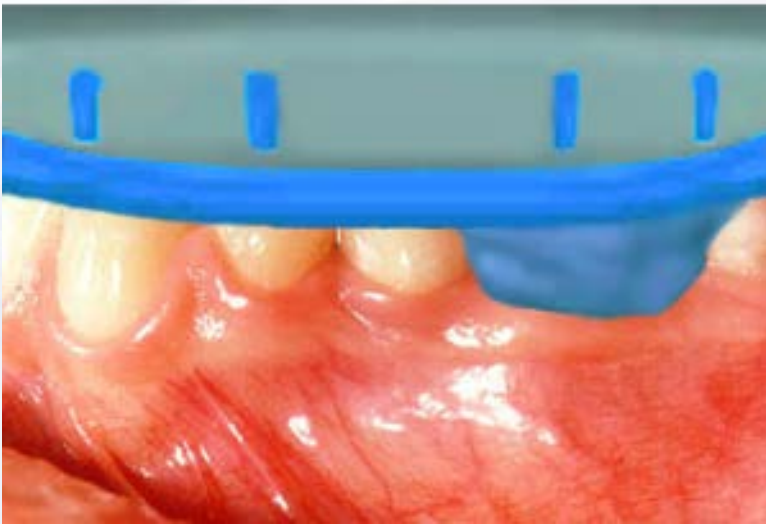

Insert tray with impression material

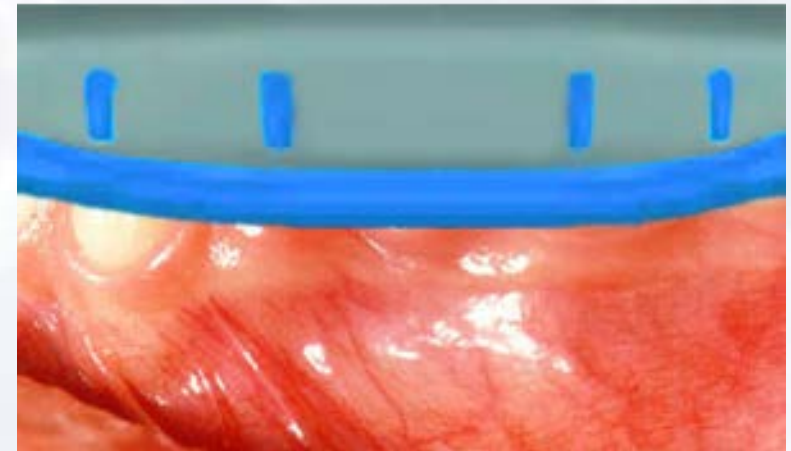

Seat impression to capture dental arch



Blue Sky Bio

KISS Quattro Abutment System

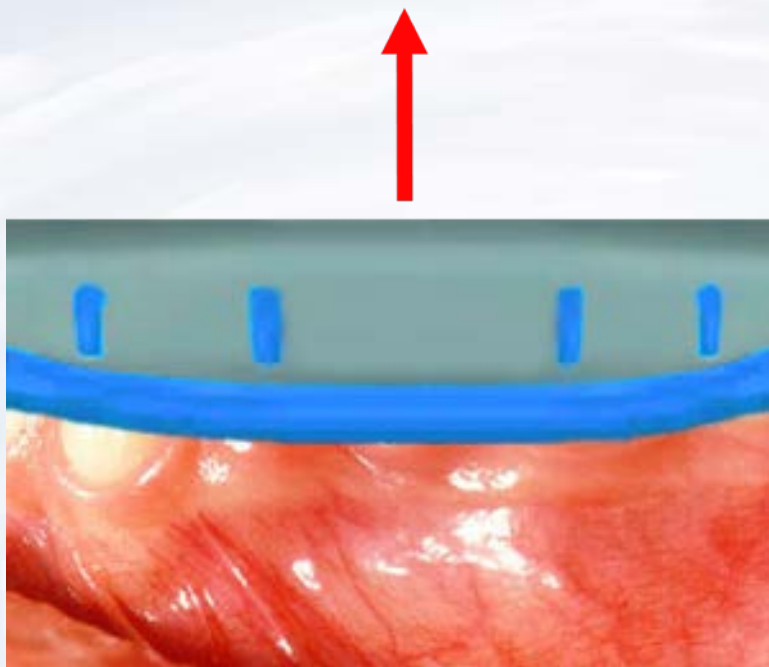

Remove the impression from the mouth when material has set

Impression snap is captured and picked up within the impression



Blue Sky Bio

KISS Quattro Abutment System

Seat the temporary resin sleeve over the abutment



Use a crown form to reline over the sleeve to create a well fitting temporary

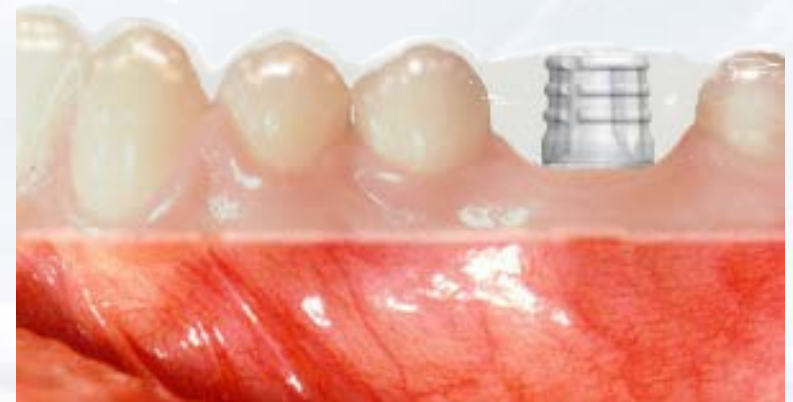

Blue Sky Bio

KISS Quattro Abutment System

Laboratory abutment analog is inserted into the impression coping. Make sure to match the grooves on the abutment analog to the lobes of the impression snap



Blue Sky Bio

KISS Quattro Abutment System

Apply soft tissue replica
material around abutment
level analog



Pour dental stone into impression



Blue Sky Bio

KISS Quattro Abutment System

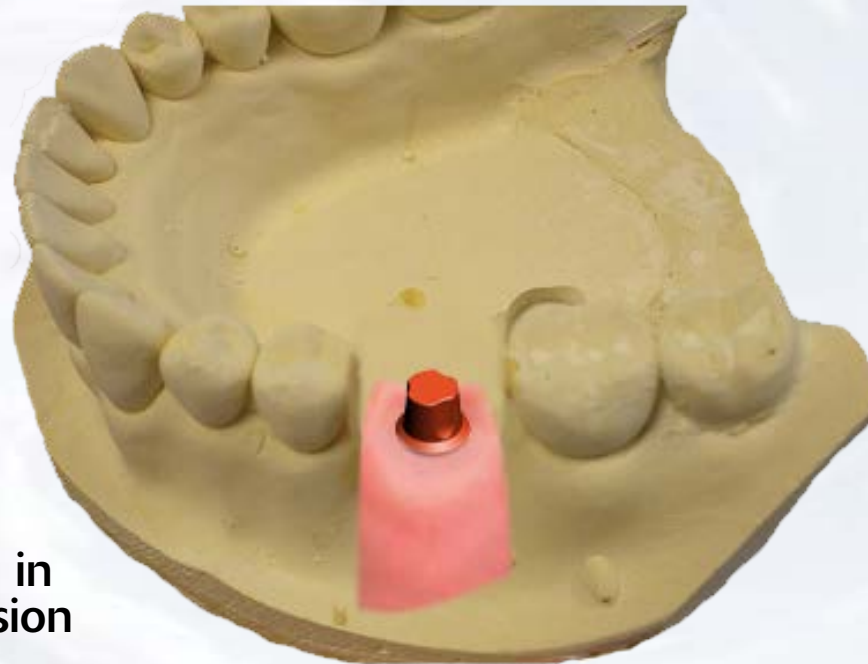

Dental stone model with analog in place after separation of impression from dried stone



Blue Sky Bio

KISS Quattro Abutment System



Engaging waxing sleeve has Double lobes to match the grooves on the abutment analog

Apply engaging waxing sleeve for a single crown, non-engaging waxing sleeve for a splinted multi-unit restoration.

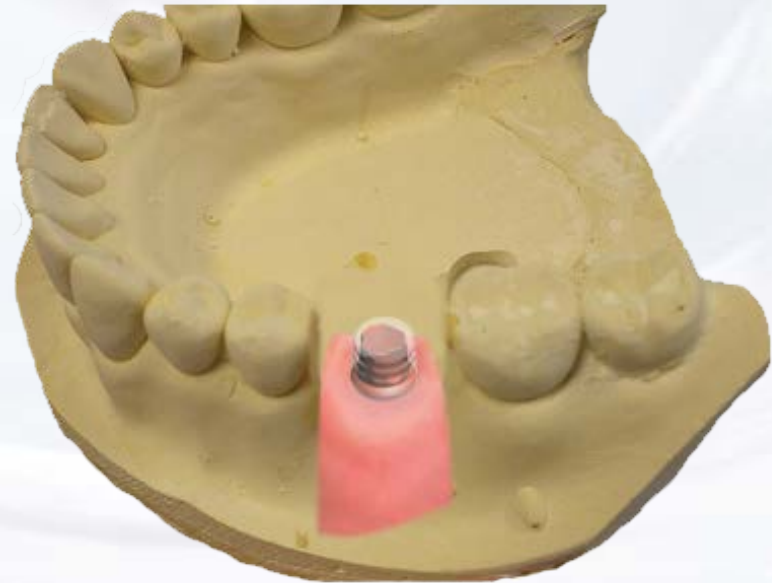

Blue Sky Bio

KISS Quattro Abutment System

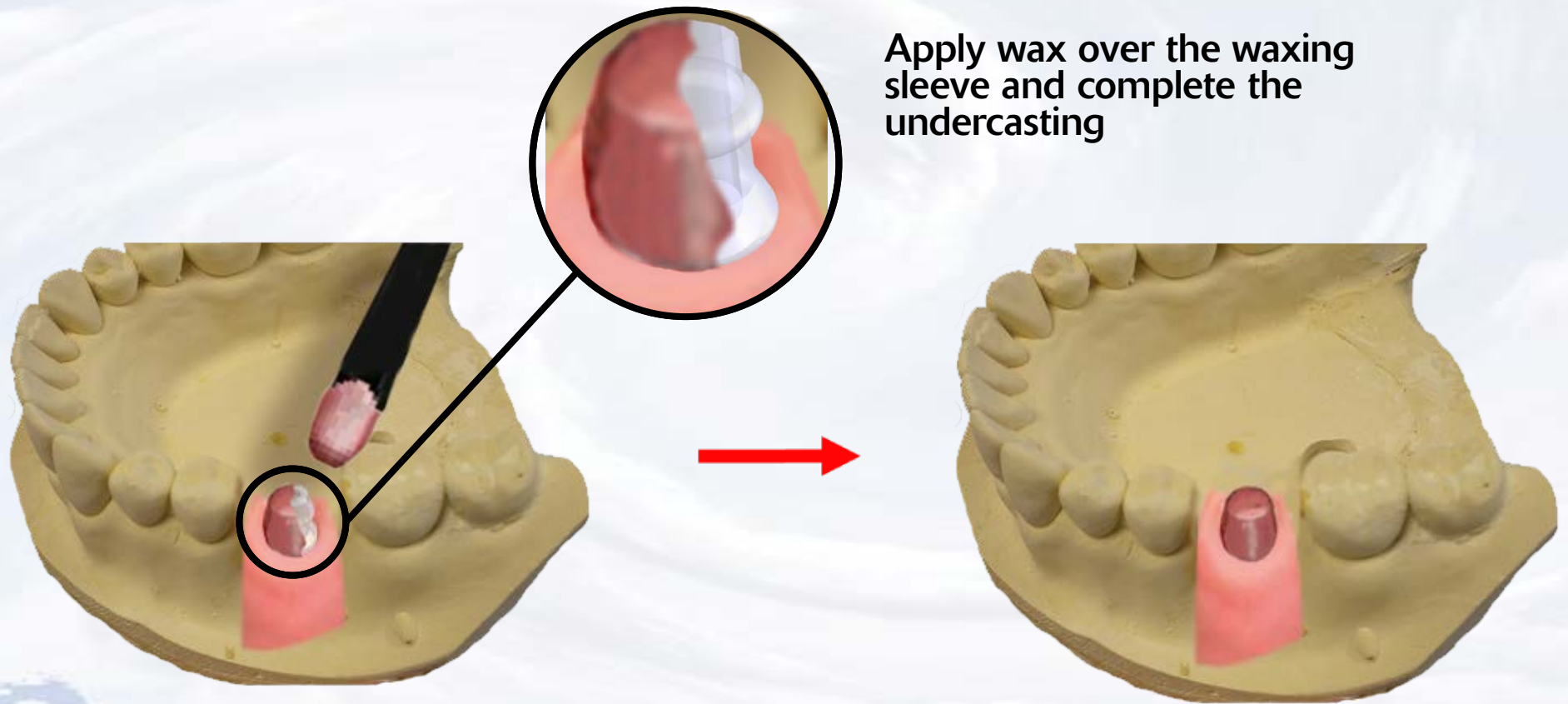

Blue Sky Bio

KISS Quattro Abutment System

Cast wax up with the usual procedures and try in the casting on the stone model



Stack and fire the ceramic in the usual manner

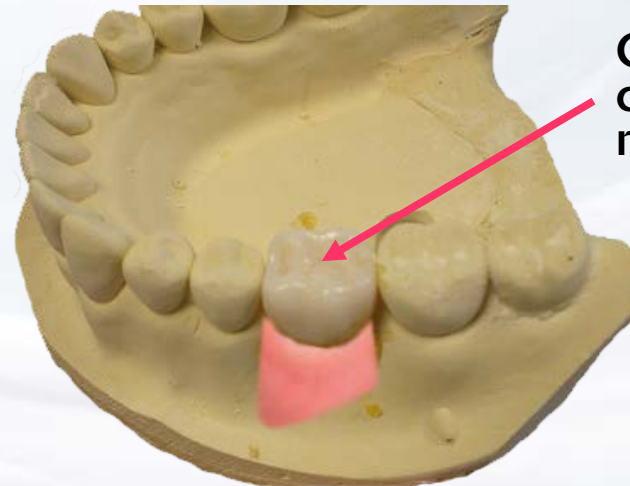

Ceramic crown on model



Blue Sky Bio

KISS Quattro Abutment System



Cement restoration on
abutment



Blue Sky Bio